

S O F I T E L

DUBAI THE PALM

SIGNATURE  
COLLECTION



# BIENVENUE!

The fabled turquoise of the Arabian Gulf, shimmering in the sun. Warm golden sand beneath your feet. The whisper of palm trees in the breeze as you drift hand-in-hand with your loved one to your intimate sanctuary concealed amid lush greenery. Will you lounge by the sparkling pool with a chilled glass of Champagne in hand? Stroll down to the tranquil beach? Or simply dream, relax and relish your exquisite retreat? Whatever you desire, it's here.

Bienvenue to **Sofitel Dubai The Palm Signature Collection**, a new boutique hotel experience for exceptional, bespoke stays on Dubai's renowned Palm Jumeirah.







# SIGNATURE PALM SUITES

A much-anticipated honeymoon, a special anniversary or a romantic getaway. Whatever the occasion, your journey of personalised luxury and exquisite art de vivre starts the moment you arrive, with a check-in area exclusive to Signature Palm Suite guests and 24-hour butler service. Unwind on the dedicated adult-friendly beach overlooking Dubai's magnificent skyline as you tailor your perfect stay from our thoughtful menu of signature experiences.



Seclusion. Sophistication. Serenity. With a dreamy four-poster bed in the master bedroom and a spacious bathroom in calming natural tones, Signature Palm Suite is an impeccable sanctuary for relaxing and indulging.

**FACILITIES & BENEFITS:**

- The Premier Lounge access
- 24-hours butler service
- Complimentary access to Sofitel FITNESS
- Master bedroom with spacious living area
- Large private balcony with sea or garden view
- Complimentary access to Sofitel SPA with L'Occitane facilities
- Freestanding bathtub and separate walk-in rain shower
- Dedicated check-in area
- Adult friendly beach
- Safety deposit box
- Bose sound system
- Spacious living room
- Sofa-bed in separate living room
- Nespresso machine and tea-making facilities
- Work area with writing table and chair





# SIGNATURE VILLAS

Each of the four villas at Sofitel Dubai The Palm Signature Collection is a singular expression of elegance, prestige and singular French joie de vivre. Arrive at your private entrance, nestled in the secluded tranquillity of our lush gardens. Immerse yourself in the grandeur of your opulent master bedroom, separate dining room and spectacular cinema. Then allow your butler to take care of all the details as you unwind in your outdoor pool or relax with friends in your spacious lounge and bar.







# EDEN VILLA

Escape to our Eden Villa with your extended family or closest friends for the utmost in privacy and tranquillity. Nestled in our immaculately manicured gardens, this exquisite suite enchants with opulent marble walls and elegant grey furnishings, balanced with exuberant flourishes of orange and gold.

Immerse yourself in the silky waters of your secluded pool or keep up with your fitness routine in your very own gym. With a private cinema, BBQ area and a spacious rooftop terrace, you are truly in a world of your own.



**FACILITIES & BENEFITS:**

- The Premier Lounge access
  - 24-hours butler service
  - Complimentary access to Sofitel FITNESS
  - Complimentary access to Sofitel SPA with L'Occitane facilities
  - Master bedroom with spacious living area
  - Freestanding bathtub tub and separate walk-in rain shower
  - Large private balcony with sea or garden view
- Spacious living room
  - Sofa-bed in separate living room
  - Nespresso machine and tea-making facilities
  - Work area with writing table and chair
  - Safety deposit box
  - Bose sound system





# PALM VILLA

A chic celebration with friends and family, or a secluded haven just for you. Whatever you desire, our Palm Villa is the epitome of impeccable sophistication, with an extraordinary outdoor pool and Jacuzzi, extensive garden and private beach.

A state-of-the-art cinema allows you to watch films in sumptuous comfort, while 24-hour butler service means you can relax knowing every last detail will be looked after. With four bedrooms and two entertainment rooms set across two floors, this is an exclusive retreat like no other.

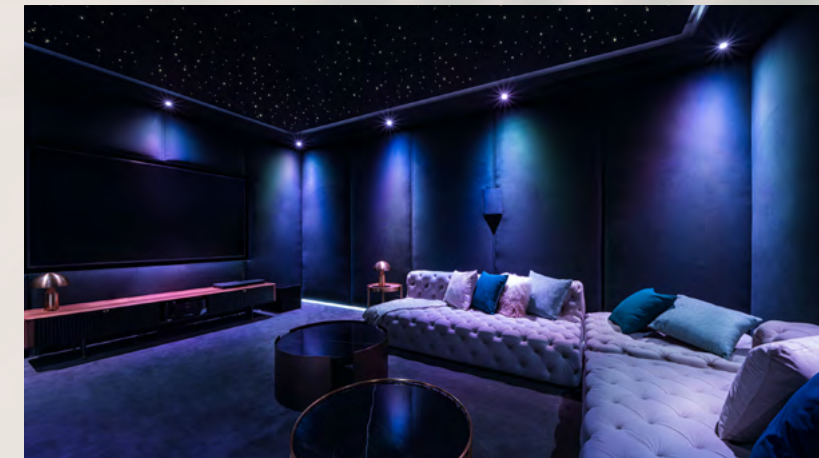





#### FACILITIES & BENEFITS:

- Contemporary decor or Polynesian decor
- Maximum occupancy: 8 adults and 2 child
- 650 - 750sqm (7,000 - 8,000 sq ft)
- Dedicated private beach
- Private swimming pool, Jacuzzi and rooftop terrace with views of Palm Jumeirah
- 24-hour butler service
- Master suite with king-size Sofitel MyBed™ & dressing room
- Three guest rooms with en-suite bathroom featuring a combination of king/twin size Sofitel MyBed™
- One butler's bedroom
- Spacious living room
- Dining room
- Fully equipped kitchen with separate entrance and service room
- Access to The Premier Lounge
- Hermès bath products
- Complimentary access to Sofitel SPA with L'Occitane facilities
- Pick-up and drop-off service to and from the Dubai International Airport







# RIVIERA VILLA

A private entrance, away from the rest of the world. Verdant gardens, concealing an opulent sanctuary. An outdoor pool and Jacuzzi, beckoning you to a free-spirited escape. Our Riviera Villa is at once lavish and welcoming, offering a sumptuous master suite, three immaculate bedrooms, a private cinema and majlis for gatherings with friends or loved ones. Linger over exquisite meals in your elegant dining room, then enjoy an indulgent evening in the luminous cocoon of your high-ceilinged lounge and bar. A rooftop terrace, overlooking the glittering Palm Jumeirah, completes your journey of secluded sophistication.



**FACILITIES & BENEFITS:**

- Contemporary decor or Polynesian decor
- Maximum occupancy: 8 adults and 2 child
- 650 - 750sqm (7,000 - 8,000 sq ft)
- Dedicated private beach
- Private swimming pool, Jacuzzi and rooftop terrace with views of Palm Jumeirah
- 24-hour butler service
- Master suite with king-size Sofitel MyBed™ & dressing room
- Three guest rooms with en-suite bathroom featuring a combination of king/twin size Sofitel MyBed™
- One butler's bedroom
- Spacious living room
- Dining room
- Fully equipped kitchen with separate entrance and service room
- Access to The Premier Lounge
- Hermès bath products
- Complimentary access to Sofitel SPA with L'Occitane facilities
- Pick-up and drop-off service to and from the Dubai International Airport

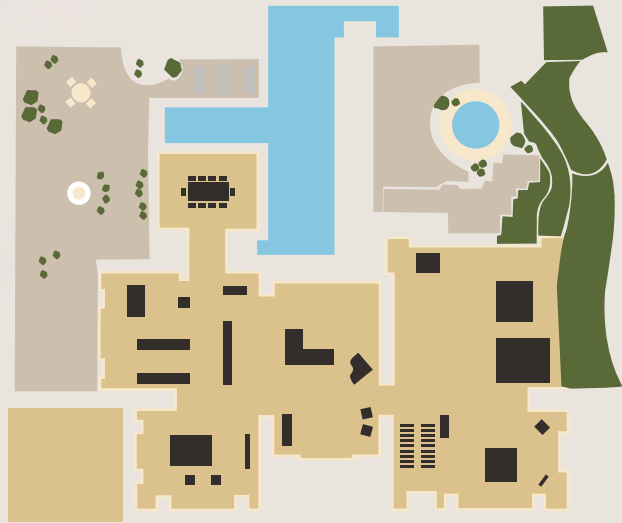



# BEACH VILLA

The gentle embrace of the warm ocean breeze. Soft golden sand, giving way to the glittering sapphire sea. A private pool and Jacuzzi, surrounded by a sun-kissed lounging deck.

Discover the blissful serenity of our distinctive Beach Villa, where your remarkable locale is surpassed only by the sumptuous comfort inside. Here, the natural wood tones are accentuated by playful pops of yellow and blue, while your sleek dining and living rooms are ideal for relaxing with family and close friends. When evening falls, savour a cocktail on your roof terrace as you gaze at Dubai's twinkling skyline.







#### FACILITIES & BENEFITS:

- Maximum occupancy: 6 adults and 1 child
- 345 sqm (3,700 sq ft)
- Direct beach access
- Private swimming pool, Jacuzzi and rooftop terrace with views of Palm Jumeirah
- 24-hour butler service
- Master suite with king-size Sofitel MyBed™ & dressing room
- One bedroom with king-size Sofitel MyBed™
- One bedroom with two twin-size Sofitel MyBed™
- One butler/nanny room
- Separate living room and dining area
- Fully equipped kitchen with separate entrance and service room
- Three bathrooms
- Hermès bath products
- Freestanding soaking tub and separate walk-in rain shower
- Access to The Premier Lounge
- Access to Sofitel SPA with L'Occitane facilities
- Pick-up and drop-off service to and from the Dubai International Airport







# FACILITIES

From our celebrated wellness facilities to our award-winning gastronomy, your voyage of luxury continues throughout your stay at Sofitel Dubai The Palm.

Discover rejuvenating and nourishing products from France's Provence region at Sofitel SPA with L'Occitane. Indulge in a restorative facial, pamper yourself with a deep-tissue massage or reserve our exclusive couple's private cabana for a signature spa package, then immerse yourself in the peaceful waters of the adults-only infinity pool.

When it's time to drink, dance and dine, stroll down to Laguna Beach Taverna & Lounge. Sip a signature cocktail as the glowing sun slips beneath the ocean horizon and lounge under the stars to DJ sets at the trendiest beach bar in Palm Jumeirah.



SOFITEL DUBAI THE PALM

PALM JUMEIRAH - EAST CRESCENT ROAD - P.O. BOX 55558 - DUBAI - UNITED ARAB EMIRATES

TEL: +971 44 55 66 77 - EMAIL: H6541@SOFITEL.COM

WWW.SOFITELDUBAITHEPALM.COM



@SOFITELDUBAIPALM